

– INSTRUCTION MANUAL

# Hospital-grade air purifier

CE UK  
CA

**RENSAIR**



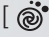

## – HOW TO GET STARTED

- 1 – Lift your Rensair air purifier out of the box.
- 2 – Place the unit in the desired location.
- 3 – Insert the power plug to your wall socket.
- 4 – Press the power button [  ] to turn it on. The unit will start in auto mode where the internal particle counter automatically adjusts airflow settings based on the surrounding air quality. To manually control the fan speed, press the fan speed button [  ] to toggle between low, medium, high and auto.
- 5 – That's it. Your Rensair air purifier is now purifying the air.

### **How to turn your Rensair air purifier off:**

Press the power button [  ] to turn the unit off.

Alternatively, you can use the timer function to determine when the Rensair air purifier will automatically switch off. Press the timer buttons [  + /  - ] to increase or decrease the remaining operating time. The control panel will display the remaining operating time.



CONTROL PANEL

AIR INLET  
PERFORATIONS

AIR OUTLET  
PERFORATIONS

WHEELS FOR  
PORTABILITY

## – CLEANING & MAINTENANCE



Always unplug the unit when cleaning or carrying out maintenance. As an added safety feature, the power will automatically switch off when the unit is tilted.

### **Cleaning the dust pre-filters**

Pre-filters should be checked for dust or dirt on a weekly basis and cleaned when necessary. Remove all four filters by pressing the small clip button at the top and lifting them up. If possible shake dust off outdoors. Use a vacuum cleaner or dry cloth to remove finer dust. If needed, use mild soap and water to wash them. Make sure the filters are completely dry before re-inserting them.

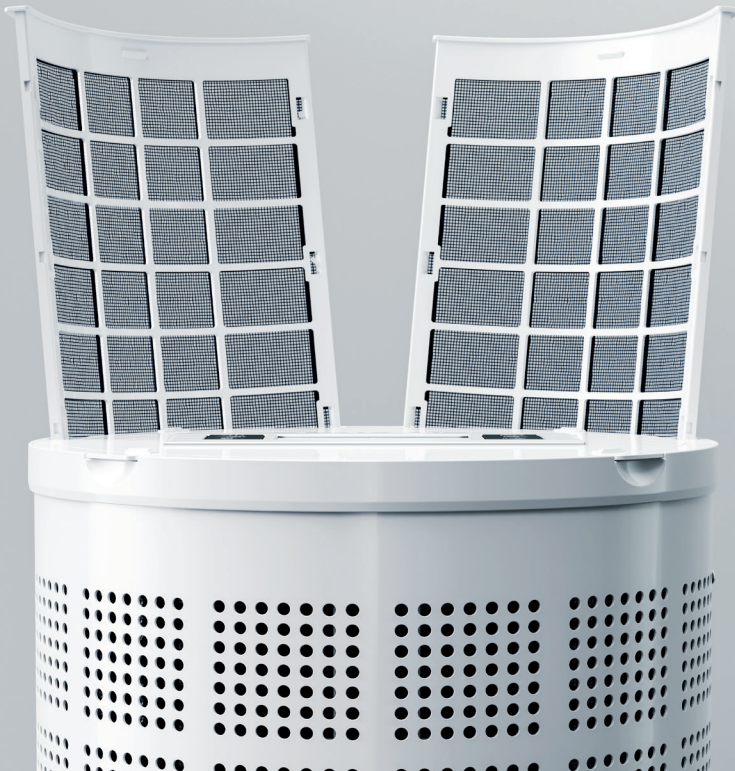

### **Cleaning the main body**

Using a soft cloth (damp if necessary), gently wipe the outside of the unit. Caution: Do not use alcohol, gasoline, thinners, acid, abrasives or any other substances which could cause damage to the surface of the main body. Water or other liquids should never enter the main body of the unit.

### **Replacing the main HEPA 13 filter and UVC lamp**

Your Rensair air purifier will run for 9000 hours before you need to replace the HEPA 13 filter and UVC lamp.

Your Rensair air purifier will automatically alert you when the parts need to be replaced via the 'service indicator' on the display panel (see page 9). Changing the HEPA 13 filter and UVC lamp is easy and can be done in five minutes. Instructions on how to change the filter and lamp will be included in the box when you order your replacement parts. Alternatively, visit **[rensair.com/maintenance](https://www.rensair.com/maintenance)** to view our online guide to changing these parts.

If you experience any issues with your Rensair air purifier please contact your distributor or email **[support@rensair.com](mailto:support@rensair.com)**



## — CONTROL PANEL

**REMOTE CONTROL:** The Rensair air purifier can also be controlled by the included remote control. The buttons on the remote control correspond to the buttons on the control panel. Note, the remote control uses 2x AAA-batteries (not included).

**ON/OFF:** When switched on, the unit will start in auto mode where the internal particle counter automatically adjusts the airflow settings based on surrounding air quality. When the air quality is good, the unit will automatically switch to standby mode. If the surrounding air particles increase the Rensair air purifier will automatically turn on again.

**UVC LAMP:** The UVC lamp will turn on by default when the unit is running. It is recommended to keep the UVC lamp on for the highest air purification effectiveness. To manually turn it on/off press the UVC lamp button.



FAN SPEED: To manually control the fan speed, press the fan speed button to toggle between low, medium, high and auto.

RENSAIR AIRFLOW VOLUME	CUBIC METERS M <sup>3</sup> /HOUR	NOISE LEVEL	POWER USAGE
Low setting	300	45dBA	160W
Medium setting	430	52dBA	180W
High setting	560	59dBA	220W

tolerance +/- 10%



TIMER + / -: Use the timer function to apply or adjust a preset running time for your Rensair air purifier. Press the +/- buttons to increase or decrease the operating time. The control panel will display the remaining operating time. The machine will automatically switch off once this time has elapsed.

#### FILTER LIFE RESET:

Note – This function should only be used after the HEPA 13 filter and UVC lamp have been changed. See cleaning and maintenance on page 4 and 5.

## – DISPLAY

### Auto

Auto mode: this is the default mode when the unit is first turned on. The Rensair air purifier will operate continuously in auto mode if the air quality is deemed unsatisfactory.



Fan speed indicator: 1 (low), 2 (medium), 3 (high).



UVC lamp on/off indicator.

### Timer

When Timer mode is in use, the display panel will indicate the remaining run time. Otherwise the panel will display the room temperature.

### Temp

The temperature indicator displays the room temperature.





The air indicator shows the quality of the air based on the number of particles entering the unit. The fewer the bars, the better.



The service indicator displays the remaining life of the HEPA 13 filter and UVC lamp. When all the bars are continuously illuminated to the illustration on the right, it is time to service the unit. Please visit [Rensair.com](https://www.rensair.com) to order a new HEPA 13 filter and UVC lamp.

For instructions on how to change the HEPA 13 filter and UVC lamp go to: **[rensair.com/maintenance](https://www.rensair.com/maintenance)**

## — SPECIFICATIONS

# Rensair Q01B

---

220-240V, ~50Hz, IEC C14 to C13 connector to allow for different power plugs, CE & UKCA marked

---

Dimensions: H:77cm, Ø37cm

---

Box Dimensions: H: 84cm x W: 43cm x D: 43cm

---

Net weight: 18kg

---

Gross Weight (including box): 21kg

---

Colour: White

---

HEPA filter: EU13 (EN 1822 class H13)

---

UVC lamp: 18W, 254nm light

---

Length of power cord: 3m

---

PRE-FILTER

FAN

UVC LAMP

HEPA 13 FILTER

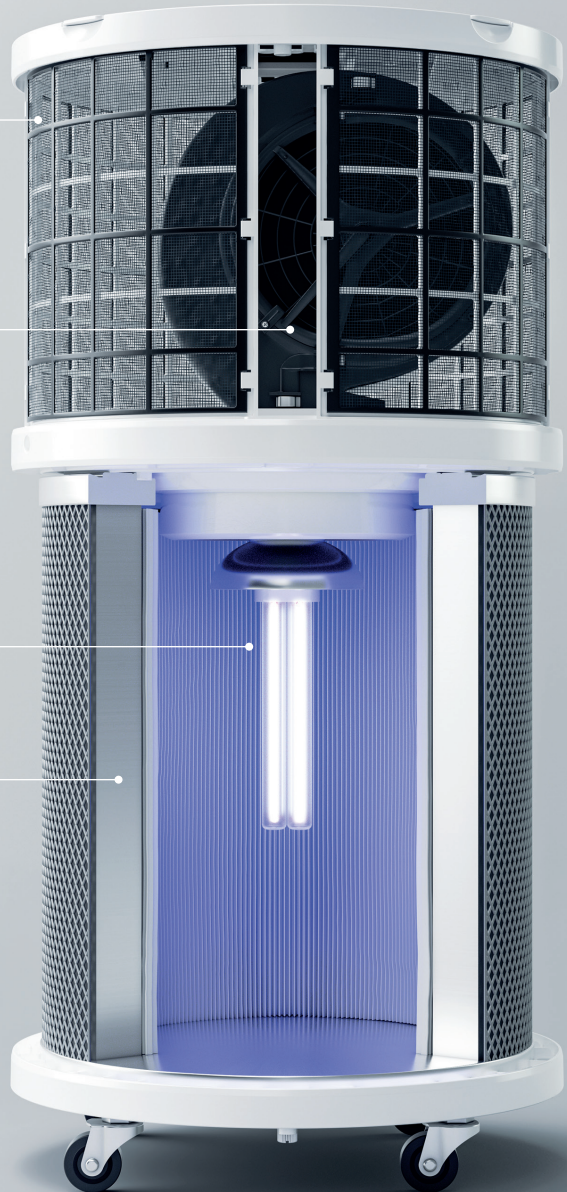



**Need another language?**

Scan the QR code or visit  
[rensair.com/Instructionmanual](https://rensair.com/Instructionmanual) to view  
the instruction manual in other languages.

---